



Contact Chamber and PoolMoss[®] Packs

Installation and Product Use Instructions

Providing
naturally pure,
healthier water.



Installation Diagrams with Contact Chamber Before the Pump:

(Installation can be done either before or after the pump. Shown below)

Before the pump is the preferred method. Plumbing in the contact chamber in this way will prevent the moss from entering the pool in the rare circumstances that the mesh loses integrity.

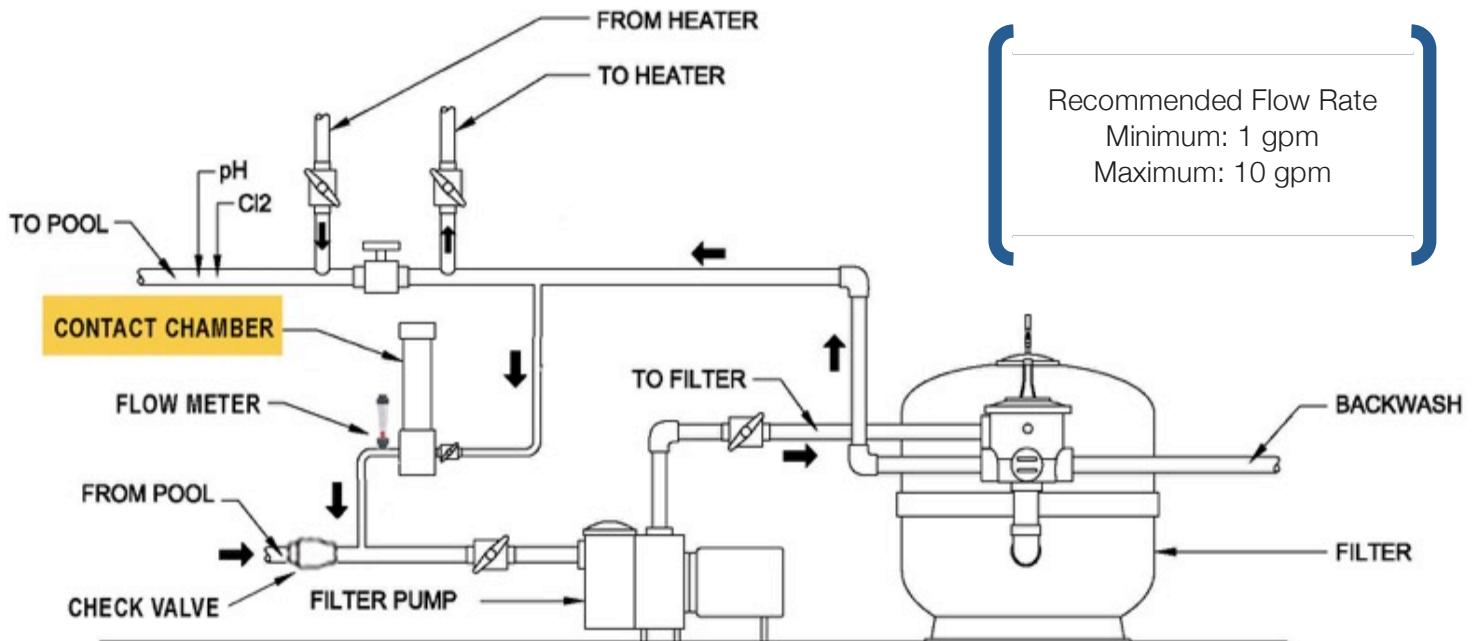

Installation Diagrams with Contact Chamber After the Pump:

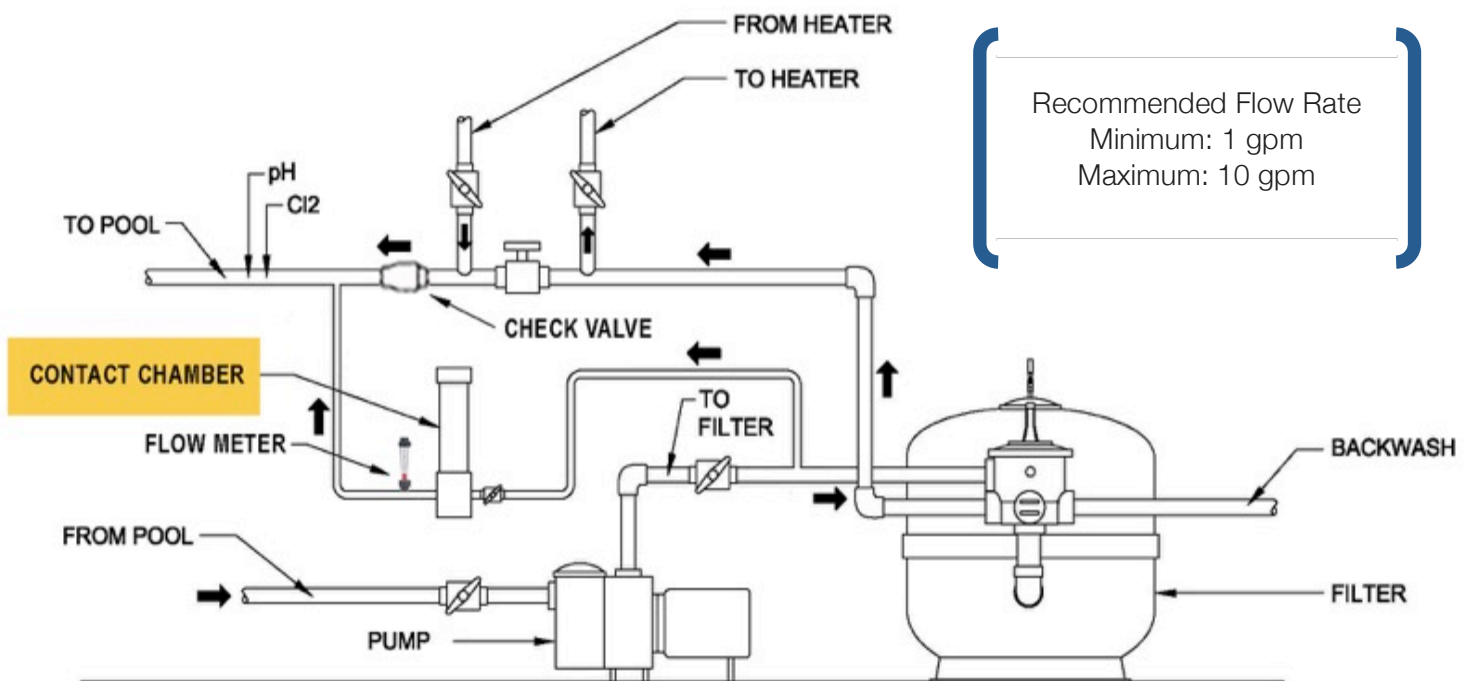

**PoolStart™ contact chamber:
9037400192-CMP**

1. Lid Assy w/ o-ring & air relief
2. Screen
3. O-ring
4. Check Ball
5. Body w/ Stand
6. Plug
7. Union
8. Threaded Coupling
9. Gasket
10. Flow Control Valve
11. Drain Valve

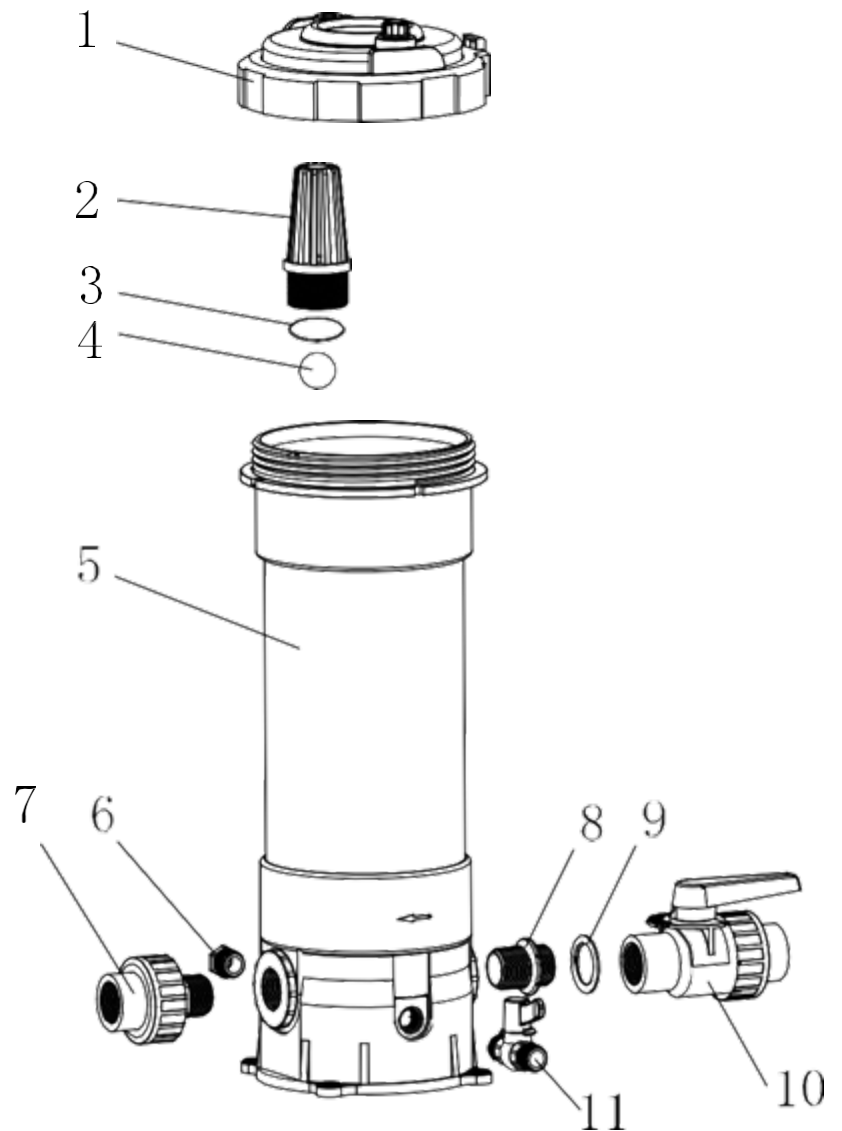

OPTIONAL EQUIPMENT (not pictured)

- 25830-350-000 1.5" Corrosion Resistant Check Valve
- 25830-400-000 2" Corrosion Resistant Check Valve
- 25280-615-600 Flow Meter Assembly

Providing
naturally pure,
healthier water.



Maintenance Instructions

Spring Start Up/Opening

- Install the PoolNaturally® system at the beginning of the pool season for best results.
- Start with a fresh filter.
 - Remove filter media (sand, DE) and replace with fresh media.
 - For best results replace cartridge filter or please ensure the cartridge is well cleaned.
- When starting/opening pool, do not add stabilizer (cyanuric acid. *If using stabilized chlorine, maintain cyanuric acid below 20 ppm) or algaecide.
- Add EPA registered pool chlorine to get recommended free chlorine level
- Adjust pH, alkalinity, and hardness to recommended levels.

Free chlorine	1-3ppm
pH	7.2-7.4
alkalinity	40-120
Cyanuric Acid (CYA)	*less than 20ppm

- Once water has been balanced, add PoolMoss® to PoolStart™ contact chamber according to the dosage chart (see detailed instructions below – Changing PoolMoss®).
- The first season you use the PoolNaturally® system, check and clean filter or backwash filter weekly for the first month. As material is shed from the pipes and pool surfaces, it will collect on/in filters and needs to be removed by rinsing or backwashing.

Routine Maintenance

- PoolMoss® dosing has been designed for best results when PoolMoss® is changed once a month (see below for details about how to change PoolMoss®).
- Maintain 1-3 ppm of free chlorine.
- Monitor pH, alkalinity, hardness, free chlorine and cyanuric acid (if using CYA or stabilized chlorine) weekly with test strips or other approved testing equipment or take water samples to your local pool retailer.

Important Pool Maintenance Note

When backwashing, hyper-chlorinating, shocking, or using algaecide, close the inflow and outflow valves to the PoolStart™. Re-open valves when chlorine levels return to 1-3 ppm free chlorine and, if using an algaecide, when it is once again safe to use your pool per algaecide instructions.

At the End of the Season (for cooler climates)

Take appropriate winterizing steps for the whole pool system. Completely empty water from the PoolStart™ contact chamber and remove PoolMoss®. Add WinterMoss™ for best results!



Providing
naturally pure,
healthier water.

Changing PoolMoss®

- To change PoolMoss®, close the inflow and outflow valves at the contact chamber.
- Open the air reliefs valve to relieve pressure
- Remove lid from the contact chamber.
- Remove old PoolMoss® and dispose.
- Add new PoolMoss® according to dosage chart below.
- Lubricate o-ring as needed.
- Install the contact chamber lid and lock ring, do not over tighten the lock ring and verify that the air relief vent is closed.
- Open the previously closed inflow and outflow valves on the PoolStart™ contact chamber.
- Slightly open the air relief valve on the cover and leave open until water flows out, the contact chamber is now full. Tighten / close the air relief valve.

 PoolMoss® For Your PoolStart™ Chamber	1 Pack of PoolMoss® Per Month	2 Packs of PoolMoss® Per Month
	Up to 75.7 m ³ Up to 20,000 Gallons	Up to 151.4 m ³ Up to 40,000 Gallons

Providing
naturally pure,
healthier water.



DATE	pH	ALKALINITY	FREE CHLORINE	TOTAL CHLORINE	COMBINED CHLORINE	HARDNESS	CYANURIC ACID



Providing naturally pure, healthier water.

GENERAL DISCLAIMERS

PoolNaturally[®], PoolStart[™] and PoolMoss[®] are intended for residential home use only. Neither PoolNaturally[®], PoolStart[™] nor PoolMoss[®] are intended to be a sanitizer or disinfectant for killing bacteria.

Terms and conditions

Satisfaction Guaranteed – 90 Day Limited Warranty.

Creative Water Solutions, LLC warrants and guarantees for ninety (90) days from the date of retail purchase or internet shipment that you will be completely satisfied with PoolNaturally[®] and the PoolNaturally[®] line of products, including without limitation to PoolNaturally[®], PoolStart[™] and PoolMoss[®].

Refund/Replacement Product Policy

In the event you find PoolNaturally[®] to be unsatisfactory for any reason within ninety (90) days after retail purchase or shipment to you, Creative Water Solutions, LLC will, at your option, provide as your one-time, exclusive remedy either (i) a 100% refund of your purchase price paid for the product said to be unsatisfactory, or (ii) replacement product delivered to you free of charge.

The amount of any refund, or the quantity of replacement product, whichever remedy is elected, shall be limited to the value of your purchase price actually paid for the unsatisfactory product purchased within the 90-day period.

Each customer is entitled to a one-time option to receive either a refund or replacement product, and any customer exercising either option shall no longer qualify for either a refund or replacement product on future purchases or use of PoolNaturally[®] products.

Limitation of Remedies, Waiver and Release of Claims

The PoolNaturally[®] Refund/Replacement Product Policy set forth above is the exclusive warranty and remedy for your use of any PoolNaturally[®] product, including without limitation to PoolNaturally[®], PoolStart[™], PoolMoss[®]. All claims for refunds are deemed waived or released unless made in accordance with the PoolNaturally[®] refund/replacement product policy.

Except as provided under the PoolNaturally[®] refund/product replacement policy, PoolNaturally[®] and all products within the PoolNaturally[®] product line are being sold on an “as is” or “with all faults” basis, and the entire risk as to the quality and performance of the goods is with the buyer. No other guarantees or warranties are made, express or implied, including, but not limited to, any implied warranty of merchantability or fitness for a particular purpose or any implied warranty arising out of a course of dealing, custom, or usage of trade.

Providing
naturally pure,
healthier water.



All other claims of negligent or unintended loss, harm, injury or wrongdoing, whether in contract, negligence, strict liability or any other unintentional tort, are deemed waived or released by you, regardless whether or not submitted under or within the PoolNaturally® refund/replacement product policy. In no event will Creative Water Solutions, LLC be liable for incidental, consequential, special or punitive damages resulting from any breach of contract, negligence or other unintentional cause.

Some states do not allow the exclusion or limitation of incidental or consequential damages, so the above limitation or exclusion may not apply to you.

For warranty claims or technical support, please contact your authorized PoolNaturally® dealer or contact us directly toll free at 877-212-6493.

Creative Water Solutions

Contact Information

13809 Industrial Park Blvd.
Plymouth, MN 55441

Phone (763) 398-0141
Fax (763) 551-2572
info@cwsnaturally.com
www.cwsnaturally.com

Many of our products are assembled by persons with disabilities supported by Lifeworks Services.

Learn more at www.lifeworks.org



Providing
naturally pure,
healthier water.

© 2017 Creative Water Solutions

V3.0